



A3 Colour Multifunction Printer

Apeos C7070 / C6570 / C5570 / C4570 / C3570



Hello to the future of work

The "Apeos" series offers advanced features with high security level and easy operability to help business diversify with times.



Quick and simple operability



High performance for greater work efficiency



Safeguard important information



Initiatives for environmental consideration

Accelerate your world of remote style

Apeos C7070/C6570/C5570/C4570/C3570

Copy/Print	Scan	Printing Resolution	Control Panel	Environmental Technology
C7070 70 ppm *1	Colour/Monochrome 270ppm *2	1,200 × 2,400 dpi	10.1 inches	LED printhead Super EA-Eco toner

•Mobile supported •Wireless LAN supported •Scan business cards •Security •LED reminder to collect printed document /originals
•Multi-feed detection

*1: For Apeos C7070

*2: When scanning using the Duplex Automatic Document Feeder C2-PC. 160 ppm when using the Duplex Automatic Document Feeder B2-PC.

Quick and simple operability

Simple layout with easy navigation

Black and gray tone UI gives better contrast for easy recognition

- Icons are evenly spread for easy recognition
- Consistent operation steps of each function for easy recall
- Home screen personalization for ease of access to commonly used functions
- Pin regular settings for registering frequent or repeated jobs
- Clear visible light notifications for completed or error jobs
- Subtle sound notification for alert and attention

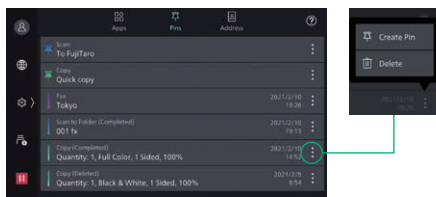

Light notification reminder

Light notification reminds user of uncollected original or printed document on the trays.

- Prevents uncollected documents left on the Center Tray or feeder
- Center Tray light further notifies when a fax is received on the Side Tray



Accelerated operations with no wait time

Quick startup and output for greater efficiency

- Quick warm up in less than 24 seconds
- Fast Boot Mode prepares the operation panel in 6 seconds*¹
- First Copy Output Time in 3.3 seconds*²

*1: Depending on the status of the main unit and configuration of options, it may not operate or take more than 6 seconds.

*2: A4 LEF for C7070/C6570 when in horizontal/Monochrome preferred mode

Flexibility in office layout

Supports wireless LAN environment*¹.

- Supports free addressing in the office with Wi-Fi support
- Up to five Wi-Fi Direct multifunction devices can be connected at the same time
- Supports direct mobile printing*²
- Print Utility, AirPrint, and Mopria® Print Service are supported

*1: Optional.

*2: When connecting to Wi-Fi Direct.

Smartphone becomes a “portable operation panel”

Seamless connectivity with mobile devices for Copy, Fax, Print, Scan*² jobs using the Print Utility*¹ application.

- Mobile device can be used as an alternative UI for operations control to minimise common touch points
- Frequent settings can be saved as “Favourites”
- Directly send fax or email with the addresses stored in the smartphone
- Minimise printer touch points for hygiene reasons

Note: Connect to machine via wireless environment or Wi-Fi direct connection.

*1: It can be downloaded free of charge from Google Play™ or App Store.

*2: E-mail, Scan to Folder.



Trays open and close lightly and quietly

Paper trays are equipped with a retraction mechanism for smooth opening and closing

- One soft push for closing
- Retracts softly and gently
- Drawing out is effortless

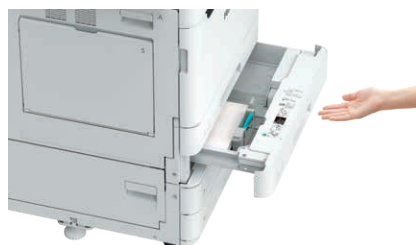

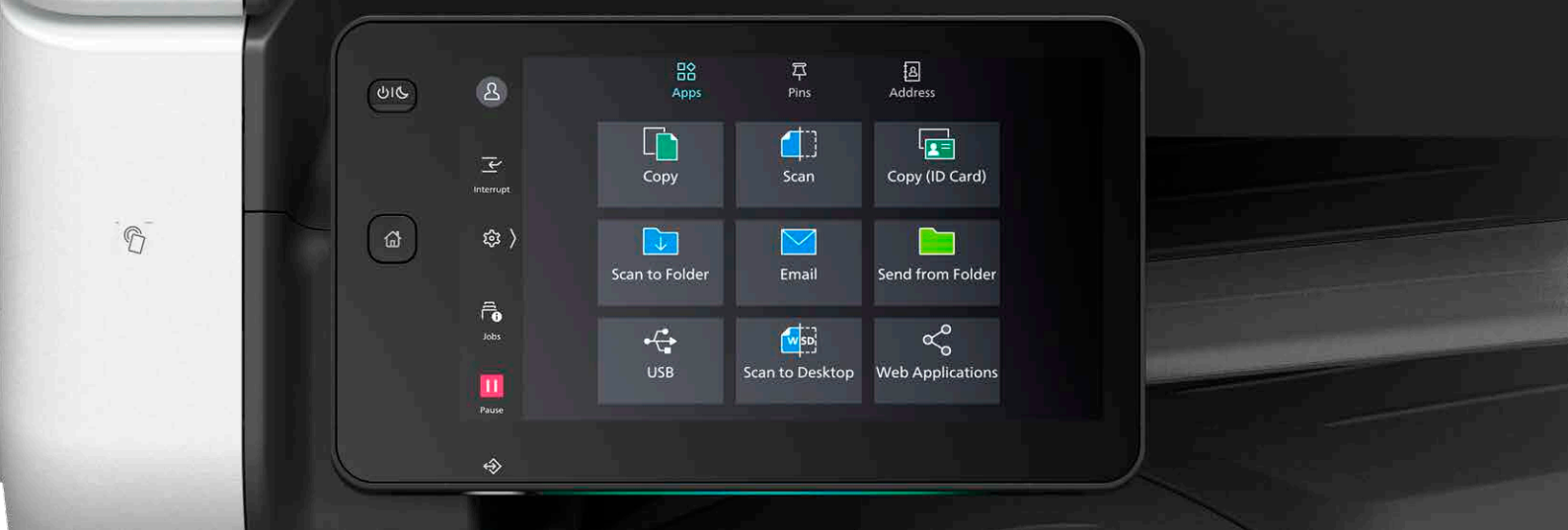

High performance for greater work efficiency

Quick scanning of high-volume originals

Up to 270ppm* can be read at high speed in Copy or Scan. The post-processing jobs can be carried out without delay.

- Equipped with multifeed detection
- One pass DADF will not damage the original document
- The document cover closes slowly

* For Duplex Automatic Document Feeder C2-PC. During 1 pass and 2 sided scanning, 200 dpi to Folder.

Scan small originals such as checks and invoices together

Custom-size or small-size documents such as receipts can be scanned directly from the Duplex Automatic Document Feeder which can be automatically set into the nearest standard size.

- Instantly scan without manual entry of each original size
- Automatically converts custom-size originals to standard size
- Smart OCR function reduces post-processing work

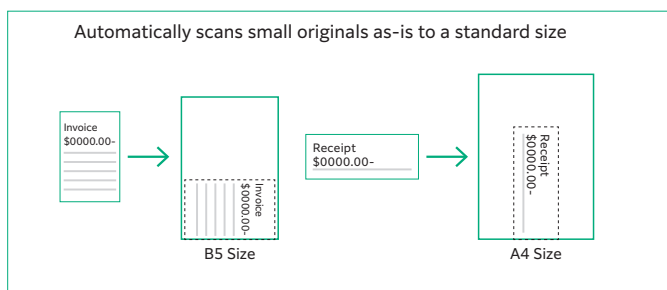

Create appealing promotional materials from various type of paper size and material

The device supports various paper size and thickness such as postcards, envelopes, and long paper. Promotional materials can be easily produced in-house

- Supports long paper up to 320 × 1,200 mm
- Supports 52 to 300 gsm paper from lightweight cardstock paper such as certificate of commendation
- Bypass tray supports postcards and envelopes



Enhance sales capabilities by utilising business card information

With Duplex Automatic Document Feeder B2-PC, you can load originals that are as small as business cards.

- Supports minimum size of 49mm(W) x 85mm(L)*
- Multiple sheets of original can be loaded and scanned together
- 1-pass 2-sided DADF allows simultaneous front and back side scanning
- OCR feature reduces workload of manual data entry



* Applicable for paper weight 38 to 209 gsm

Various features saving time and effort in scanning operation

Scanned data can be transferred through a variety of methods including Email, URL, and send to PC (SMB/FTP/SFTP).

- Data can be sent by using multiple features simultaneously
- Improve your digitalisation process with features including automatic orientation of scanned page to upright position, correcting the skewed page, or removing blank pages
- In addition to TIFF and JPEG, the scanned data can be converted to PDF with searchable OCR enabled

Safeguard important information

Information is an important asset which should be protected at all cost

Protect from unauthorised user

Multiple options of setting user authorisation allow administrator to select a right combination as per given environment.

- Local Authentication
- Authentication by Remote Server
- IC Card Authentication*
- User-specific feature access
- Private Charge Print

* Optional.

Additional layer of unwanted access can be created for specific users. (e.g. guests).

- Secondary Ethernet Kit*

* Optional.

Protects Data

Protects against any malicious intent of hacking, tampering with device / system settings.

- Encryption of stored data
- Uses TPM* 2.0 chip for encryption key management
- Deletes settings and document information all at once

* Trusted Platform Module

Protects the information by means of strong encryption while transferring it between devices, servers etc.

- Encryption of communication paths by SSL/TLS or IPsec
- Encryption when transferring via SMBv3 and SFTP
- Scan file encryption/signature
- Email encryption and signature by S/MIME
- TLS version limit
- Elliptic curve cryptography
- WPA3

Protect from unauthorised access

Protects device settings at multiple levels by clearly demarking change restrictions for different target audience - End users, IT administrators and Service Engineers.

- Service representative operation restriction
- Account lock to prevent unauthorised access
- Information for changing the default password
- Warnings displayed when using global IP address

Prevents unauthorised program from installing without notice. Robust IT audits are supported with device data logs for easy tracking.

- Software signature verification
- Remote update restrictions
- IP address filtering
- Tampering detection at startup and automatic restoration when tampering is detected
- Prevention of tampering during operation
- Audit log
- Audit log system transfer

Prevents operation errors

Prevents information leakage due to inadvertent mistakes by administrators and users.

- Scan documents to be delivered to fixed destination
- Re-enter fax recipient
- Annotations
- Watermark

Initiatives for environmental consideration



We are working to develop environmentally conscious products, including technologies that reduce the power consumption of multifunction devices and printers to achieve lower environmental impact. Fujifilm Group introduced the certification program in which we clarify the environmental value of each product by assessments at the time of product development, conduct the evaluation based on our in-house certification criteria and certify the products* that are excellent in reducing environmental impact as "Green Value Products". This product was certificated as a "Gold" rank product that contributes to reduction of environmental impact at industries' highest level.

* Products and services excellent in reducing environmental impact are those designed in consideration of environmental impact throughout their life cycle from acquisition of raw materials, production, usage, disposition, to reuse.

Initiatives for energy conservation

- Achieve both energy conservation and customer convenience by adopting IH fusing technologies that enable quick heating to eliminate the necessity of preheating in standby or power-saving mode
- Achieve both high image quality and energy conservation by equipping the LED printhead that enables space and energy saving design, as well as Super EA-Eco toner that has low-temperature fusing performance

- Reduce the power consumption with the smart power saving feature that solely powers on the required parts according to the functions being used by customers

Initiatives for resources conservation

- Functions contributing to paper consumption reduction
 - Private Charge Print, Scan, Paperless Fax, Pages per Side/Multiple-Up etc.

Apeos C7070 / C6570 / C5570 / C4570 / C3570

Functions & Specifications

Basic Specifications/Copy Function

Item	Description					
	C7070	C6570	C5570	C4570	C3570	
Type	Console					
Memory capacity	4 GB (Max: 4 GB)					
Storage Device Capacity*	128 GB					
Colour Capability	Full colour					
Scan Resolution	600 x 600 dpi					
Printing Resolution	1,200 x 2,400 dpi (Text-Photo / Photo), 600 x 600 dpi (Text / Map)					
Warm-up Time	[Embedded Plug-ins / Custom Services] *2 When enabled: 30 seconds or less (23 degrees Celsius room temperature) When disabled: 24 seconds or less (23 degrees Celsius room temperature)					
Recovery Time (Recovery Time from Sleep mode)	13 seconds or less (23 degrees Celsius room temperature)		11 seconds or less (23 degrees Celsius room temperature)		5 seconds or less (23 degrees Celsius room temperature)	
Original Size	Maximum of A3, 11 x 17", 297 x 432 mm for both Sheet and Book					
Paper Size	Max	SRA3 (320 x 450 mm), 12 x 18" (305 x 457 mm), A3 (12 x 19" (305 x 483 mm), 320 x 483 mm / 12.6 x 19.1" when using Bypass Tray)				
	Min	A5, Postcard (100 x 148 mm) [89 x 98 mm / 3.5 x 3.9" when using Bypass Tray]				
	Image loss width**3	Lead edge 4.0 mm, Trail edge 2.0 mm, Right/Left edge 2.0 mm				
Paper Weight**4	Paper Tray	52 to 300 gsm / 14 lb. bond to 111 lb. cover				
	Bypass Tray	52 to 300 gsm / 14 lb. bond to 111 lb. cover				
First Copy Output Time	B/W**5	3.3 sec.	3.7 sec.	4.4 sec.	4.9 sec.	
	Colour**6	4.1 sec.	5.2 sec.	5.7 sec.	6.7 sec.	
Continuous Copy Speed**7	A4 LEF/ JIS B5 LEF	B/W: 70 ppm Colour: 70 ppm	B/W: 65 ppm Colour: 65 ppm	B/W: 55 ppm Colour: 55 ppm	B/W: 45 ppm Colour: 45 ppm	B/W: 35 ppm Colour: 35 ppm
	Letter	B/W: 70 ppm Colour: 70 ppm	B/W: 65 ppm Colour: 65 ppm	B/W: 55 ppm Colour: 55 ppm	B/W: 45 ppm Colour: 45 ppm	B/W: 35 ppm Colour: 35 ppm
	A4 / JIS B5	B/W: 50 ppm Colour: 50 ppm	B/W: 47 ppm Colour: 47 ppm	B/W: 40 ppm Colour: 40 ppm	B/W: 32 ppm Colour: 32 ppm	B/W: 27 ppm Colour: 27 ppm
	JIS B4	B/W: 41 ppm Colour: 41 ppm	B/W: 38 ppm Colour: 38 ppm	B/W: 32 ppm Colour: 32 ppm	B/W: 26 ppm Colour: 26 ppm	B/W: 23 ppm Colour: 23 ppm
	Legal	B/W: 41 ppm Colour: 41 ppm	B/W: 38 ppm Colour: 38 ppm	B/W: 32 ppm Colour: 32 ppm	B/W: 26 ppm Colour: 26 ppm	B/W: 22.5 ppm Colour: 22.5 ppm
	A3	B/W: 35 ppm Colour: 35 ppm	B/W: 32 ppm Colour: 32 ppm	B/W: 27 ppm Colour: 27 ppm	B/W: 22 ppm Colour: 22 ppm	B/W: 19 ppm Colour: 19 ppm
	Paper Tray Capacity**8	Standard	4 Tray Model: 520 sheets x 4-tray + Bypass Tray 90 sheets Tandem Tray Model: 520 sheets x 2-tray + 840 sheets + 1230 sheets + Bypass Tray 90 sheets			
	Optional	High Capacity Feeder B1: 2,000 sheets				
	Max	4 Tray Model: 4,170 sheets (4 Tray Model + High Capacity Feeder B1) Tandem Tray Model: 5,200 sheets (Tandem Tray Model + High Capacity Feeder B1)				
Output Tray Capacity**9	Upper Center: 250 sheets (A4 LEF), Lower Center: 250 sheets (A4 LEF)					
Power Supply	AC220-240 V ±10%, 10 A, 50/60 Hz common					
Maximum Power Consumption	2.2 kW (AC220 V) 2.4 kW (AC240 V) Sleep mode: 0.5 W (AC230 V) Ready mode: 110 W (AC230 V)	2.2 kW (AC220 V) 2.4 kW (AC240 V) Sleep mode: 0.5 W (AC230 V) Ready mode: 98 W (AC230 V)	2.4 kW (AC220 V) 2.4 kW (AC240 V) Sleep mode: 0.5 W (AC230 V) Ready mode: 98 W (AC230 V)	2.4 kW (AC220 V) 2.4 kW (AC240 V) Sleep mode: 0.5 W (AC230 V) Ready mode: 57 W (AC230 V)	2.2 kW (AC220 V) 2.4 kW (AC240 V) Sleep mode: 0.5 W (AC230 V) Ready mode: 57 W (AC230 V)	
	Dimensions	W 658 x D 790 x H 1169 mm / W 25.9 x D 31.1 x H 46.1"	[4 Tray Model (DADF B2-PC)] W 658 x D 720 x H 1119 mm / W 25.9 x D 28.4 x H 44.1"		W 633 x D 677 x H 1119 mm / W 25.0 x D 26.7 x H 44.1"	
Weight**10	156 kg / 344 lb.	[4 Tray Model (DADF B2-PC)] 129 kg / 285 lb.		124 kg / 274 lb.		

Note: Up to A4 size for Tray1(C3570)

*1 : The Storage Device Capacity is not totally available for customers.

*2 : Embedded Plug-ins / Custom Services are enabled as factory default. You can change the settings if needed.

*3 : Up to A3 size.

*4 : It is recommended to use our recommended paper. Correct print output may not be possible depending on the requirement.

*5 : A4 LEF or Letter LEF / Monochrome priority mode.

*6 : A4 LEF or Letter LEF / Colour priority mode.

*7 : The speed may be reduced due to the image quality adjustment.

*8 : 80 gsm paper.

*9 : 70 gsm paper.

*10: Excluding Toner Cartridge.

Print Function

Item	Description	
Type	Built-in type	
Continuous Print Speed**1	Same as the Basic Specifications / Copy Function	
Printing Resolution	Standard	[PCL Driver] Standard: 1,200 x 2,400 dpi, High Quality: 1,200 x 2,400 dpi, High Resolution: 1,200 x 1,200 dpi
	Optional	[Adobe® PostScript® 3™ Driver] High Speed (Standard): 600 x 600 dpi, High Quality: 1,200 x 2,400 dpi, High Resolution: 1,200 x 1,200 dpi
Page Description Language	Standard	PCL5 / PCL6
	Optional	Adobe® PostScript® 3™
Supported Operating System**2	Standard	[PCL Driver] Windows 11 (64 bit), Windows 10 (32 bit / 64 bit) Windows Server 2022 (64 bit), Windows Server 2019 (64 bit), Windows Server 2016 (64 bit) [Mac OS X Driver] macOS 13 / 12 / 11 / 10.15
	Optional	[Adobe® PostScript® 3™ Driver] Windows 11 (64 bit), Windows 10 (32 bit / 64 bit), Windows Server 2022 (64 bit), Windows Server 2019 (64 bit), Windows Server 2016 (64 bit) macOS 13 / 12 / 11 / 10.15
Interface	Standard	Ethernet 1000BASE-T / 100BASE-TX / 10BASE-T, USB3.0
	Optional	Wireless LAN (IEEE 802.11 a / b / g / n / ac)

*1: The speed may be reduced due to the image quality adjustment. The printing speed may be reduced depending on the document.

*2: Please refer to our official website for the latest supported OS.

Scan Function

Item	Description	
Type	Colour Scanner	
Scan Resolution	600 x 600 dpi, 400 x 400 dpi, 300 x 300 dpi, 200 x 200 dpi	
Scan Speed	Same as the Scan Speed for the Duplex Automatic Document Feeder	
Interface	Standard	Ethernet 1000BASE-T / 100BASE-TX / 10BASE-T
	Optional	Wireless LAN (IEEE 802.11 a / b / g / n / ac)

Fax Function (Optional)

Item	Description
Original Size	Max: A3, 11 x 17"; Long document (Longest 600 mm / 23.7")
Recording Paper Size	Max: A3, 11 x 17"; Min: A5
Transmission Time	2 seconds and more but fewer than 3 seconds*
Transmission Mode	ITU-T G3
Applicable Lines	Telephone subscriber line, PBX, Fax communication (PSTN)

* When A4 size document with approximately 700 characters is transmitted in standard image-quality (8 x 3.85 lines/mm) and in high-speed mode (28.8 kbps or faster, JBIG). Only indicates the time for transmitting the image information and does not include the communication control time. The total communication time will vary depending on the contents of the document, the type of machine receiving the fax, and line condition.

Duplex Automatic Document Feeder B2-PC

Item	Description			
	C5570	C4570	C3570	
Original Size / Paper Weight	Max: A3, 11 x 17"; Min: A6**1 38 to 128 gsm / 11 lb. bond to 34 lb. bond (In Duplex: 50 to 128 gsm / 14 lb. bond to 34 lb. bond) *2			
Capacity**3	130 sheets			
Scan Speed**4	Copy (A4 LEF, Simplex)	B/W: 55 ppm Colour: 55 ppm	B/W: 45 ppm Colour: 45 ppm	B/W: 35 ppm Colour: 35 ppm
	Scan	B/W: 80 ppm, Colour: 80 ppm (1 pass, 2 sided scanning: B/W 160 ppm, Colour 160 ppm) [Standard Document (A4 LEF), 200 dpi, to Folder.] B/W: 80 ppm, Colour: 80 ppm (1 pass, 2 sided scanning: B/W 160 ppm, Colour 160 ppm) [Standard Document (Letter LEF), 200 dpi, to Folder.]		

*1: The minimum custom size is 49 x 85 mm / 2.0 x 3.4".

*2: Custom sizes from 49 x 85 mm to 55 x 91 mm are available from 38 to 209 gsm.

*3: 70 gsm paper.

*4: The scanning speed varies depending on the documents.

Duplex Automatic Document Feeder C2-PC

Item	Description		
	C7070	C6570	
Original Size / Paper Weight	Max: A3, 11 x 17"; Min: A6**1 38 to 200 gsm / 11 lb. bond to 34 lb. bond (In Duplex: 50 to 200 gsm / 14 lb. bond to 53 lb. bond)		
Capacity**2	250 sheets		
Scan Speed**3	Copy (A4 LEF, Simplex)	B/W: 70 ppm Colour: 70 ppm	B/W: 65 ppm Colour: 65 ppm
	Scan	B/W: 135 ppm, Colour: 135 ppm (1 pass, 2 sided scanning: B/W 270 ppm, Colour 270 ppm) [Standard Document (A4 LEF), 200 dpi, to Folder.] B/W: 135 ppm, Colour: 135 ppm (1 pass, 2 sided scanning: B/W 270 ppm, Colour 270 ppm) [Standard Document (Letter LEF), 200 dpi, to Folder.]	

*1: The minimum custom size is 84 x 139.7 mm / 3.3 x 5.5".

*2: 70 gsm paper.

*3: The scanning speed varies depending on the documents.

Side Tray

Item	Description
Paper Capacity*	100 sheets
Dimensions	W 327 x D 414 x H 179 mm / W 12.9 x D 16.3 x H 7.1"

*: 70 gsm paper.

High Capacity Feeder B1 (Optional)

Item	Description
Paper Size	A4 LEF, Letter LEF, JIS B5 LEF
Paper Weight	55 to 216 gsm / 15 lb. bond to 57 lb. bond
Feeding Capacity / Number of Tray*	2,000 sheets x 1-tray
Dimensions	W 389 x D 610 x H 377 mm / W 15.4 x D 24.2 x H 15.0"
Weight	29 kg / 64 lb.

*: 80 gsm paper.

Finisher-B4 (Optional)

Item	Description	
Type	Sort (Offset available*1*2) / Stack (Offset available*1*2)	
Paper Size*3	Max: A3, 11 x 17"; Min: A5	
Paper Weight*4	52 to 300 gsm	
Paper Capacity*5	[Without Stapling] A4: 2,000 sheets, JIS B4 or larger: 1,000 sheets, Mixed Size Stacking*6: 300 sheets [With Stapling] A4: 100 sets or 1,000 sheets*7, JIS B4 or larger: 75 sets or 750 sheets [With Booklet Finishing*8] 50 sets or 600 sheets [With Fold*8] 500 sheets	
Staple	Capacity	50 sheets (90 gsm or less)
	Paper Size*9	Max: A3, 11 x 17"; Min: A5 LEF
	Paper Weight	52 to 256 gsm
	Position	Single stapling, Dual stapling
Punch*10	Number of Holes	2-hole / 4-hole punch
	Paper Size*11	Max: A3, 11 x 17"; Min: A5 LEF
	Paper Weight	52 to 220 gsm
Booklet Finishing*8	Capacity	Saddle Staple: 15 sheets; Single Fold: 5 sheets
	Paper Size	Max: A3, 11 x 17"; Min: A4, Letter
	Paper Weight	Saddle Staple: 64 to 80 gsm*12, Single Fold: 64 to 105 gsm
Dimensions*13	W 592 x D 653 x H 1041 mm / W 23.3 x D 25.7 x H 41.0" With Booklet Maker Unit: W 592 x D 673 x H 1076 mm / W 23.3 x D 26.5 x H 42.4"	
Weight	26 kg / 58 lb. Punch Kit: + 2 kg / 5 lb. Booklet Maker Unit: + 10 kg / 22 lb.	

*1 : The offset feature is set to disabled by factory default. The setting can be changed as necessary.

*2 : Outputs whose weight is 257 gsm and more or width is less than 210 mm are delivered without offset stacking.

*3 : Paper in the sizes larger than A3 or 11 x 17" or smaller than A5 are delivered to the Centre Tray.

*4 : Documents may not be printed correctly depending on usage conditions. (52 to 55 gsm, 257 gsm and more)

*5 : 70 gsm paper.

*6 : When larger size sheets are stacked on top of smaller size sheets.

*7 : 75 sets or 750 sheets with dual stapling.

*8 : The Booklet Finishing function requires the optional Booklet Maker Unit for Finisher-B. Make a crease allows you to fold easily. After a job with the Booklet Finishing function specified has been output, the next job may not be delivered until the sheets are removed from the output tray. Also, if larger size sheets are stacked on top of smaller size sheets after a job with the Booklet Finishing function specified has been run, the next job may not be delivered until the sheets are removed from the output tray.

*9 : Available staple positions vary depending on the paper size.

*10 : The Punch function requires the optional 2/4 Hole Punch Kit for Finisher-B.

*11 : Available number of punch holes varies depending on the paper size.

*12 : Covers can be up to 220 gsm (Extra Heavyweight).

*13 : Inner connector within the body is excluded.

Finisher-C4 / Finisher-C4 with Booklet Maker (Optional)

Item	Description		
	Finisher-C4	Finisher-C4 with Booklet Maker	
Type	Output Tray	Sort (Offset available) / Stack (Offset available)	
	Finishing Tray	Sort (Offset available) / Stack (Offset available)	
	Booklet Tray	- / Sort / Stack	
Paper Size	Output Tray	Max: 12 x 19" (305 x 483 mm), A3; Min: A6, Postcard (100 x 148 mm)	
	Finishing Tray	Max: 12 x 19" (305 x 483 mm), A3; Min: A5 LEF	
Paper Weight	Output Tray	52 to 300 gsm*1	
	Finishing Tray	52 to 300 gsm*1	
Paper Capacity*2	Output Tray	500 sheets (A4)	
	Finishing Tray	[Without Stapling] A4: 3,000 sheets, JIS B4 or larger: 1,500 sheets, A5 LEF: 1,000 sheets, Mixed Size Stacking*3: 300 sheets [With Stapling]	[Without Stapling] A4: 1,500 sheets, JIS B4 or larger: 1,500 sheets, A5 LEF: 1,000 sheets, Mixed Size Stacking*3: 300 sheets [With Stapling]
		A4: 200 sets or 3,000 sheets JIS B4 or larger: 100 sets or 1,500 sheets A5 LEF: 100 sets or 1,000 sheets Mixed Size Stacking*3: 70 sets or 200 sheets	A4: 200 sets or 1,500 sheets JIS B4 or larger: 100 sets or 1,500 sheets A5 LEF: 100 sets or 1,000 sheets Mixed Size Stacking*3: 70 sets or 200 sheets
	Booklet Tray	- / 20 sets*4	
Staple	Capacity	50 sheets (90 gsm or less)	
	Paper Size*5	Max: A3, 11 x 17"; Min: A5 LEF	
	Paper Weight	52 to 300 gsm	
Punch*6	Position	Single stapling, Dual stapling	
	Number of Holes	2-hole / 4-hole punch	
	Paper Size*7	Max: A3, 11 x 17"; Min: A5 LEF	
Booklet Finishing	Paper Weight	52 to 220 gsm	
	Capacity*8	- / Saddle Staple: 20 sheets (90 gsm or less) Single Fold: 5 sheets (90 gsm or less)	
	Paper Size	- / Max: SRA3 (320 x 450 mm), 12 x 18" (305 x 457 mm), A3; Min: JIS B5	
Dimensions*9	Paper Weight	- / Saddle Staple: 60 to 300 gsm Single Fold: 60 to 300 gsm	
	W 644 x D 692 x H 1054 mm / W 25.4 x D 27.3 x H 41.5"	W 649 x D 692 x H 1054 mm / W 25.6 x D 27.3 x H 41.5"	
		When Folder Unit CD3 is installed: W 883 x D 692 x H 1054 mm / W 34.8 x D 27.3 x H 41.5"	When Folder Unit CD3 is installed: W 888 x D 692 x H 1054 mm / W 35.0 x D 27.3 x H 41.5"
Weight	Finisher-C4 (w Punch): 44 kg / 97 lb. Folder Unit CD3: + 52 kg / 115 lb.	Finisher-C4 with Booklet Maker (w Punch): 57 kg / 126 lb. Folder Unit CD3: + 52 kg / 115 lb.	

Note: Transport Unit H4 is required.

*1: 52 to 55 gsm output paper may not be aligned properly depending on the paper type.

*2: 70 gsm paper.

*3: When larger size sheets are stacked on top of smaller size sheets.

*4: When the output paper size is the same.

*5: Available staple positions vary depending on the paper size.

*6: Punching function cannot be added. Select a finisher with the hole punching function.

*7: Available number of punch holes varies depending on the paper size.

*8: The maximum number of sheets varies depending on the paper weight. Booklet may not be tightly closed depending on the size or type of the paper.

*9: Inner connector within the body is excluded.

Folder Unit CD3 (Optional)

Item	Description	
Z Fold Half Sheet	Paper Size	A3, 11 x 17", JIS B4
	Paper Weight	60 to 90 gsm
Tri-fold	Paper Size	A4, Letter
	Paper Weight	60 to 90 gsm
	Paper Capacity*1	40 sheets
Power Supply*2 / Maximum Power Consumption	AC110 V ±10%, 0.9 A, 60 Hz, 100 W AC220-240 V ±10%, 0.6 A, 50/60 Hz common, 144 W	
Dimensions	W 232 x D 588 x H 991 mm / W 9.2 x D 23.2 x H 39.1"	
Weight	52 kg / 115lb.	

Note: Optional of Finisher-C4 / Finisher-C4 with Booklet Maker.

*1: 70 gsm paper.

*2: Power supply separate from the main unit is required.

Notes

- To comply with paper weight specifications, it is recommended to use our recommended paper. Document may not be printed correctly depending on usage conditions.
- Functional spare parts will be available for at least 7 years after the product is no longer manufactured.

Hardware configuration

Choice of main unit to your requirement

1. Duplex Automatic Document Feeder C2-PC

- 250 sheets capacity
- Scan Speed:
Simplex 135 ppm
Duplex 270 ppm

2. Duplex Automatic Document Feeder B2-PC

- 130 sheets capacity
- Scan Speed:
Simplex 80 ppm
Duplex 160 ppm

Standard value

3 ways output tray

Allows to separate the print output each copy, fax and print job



5. Side Tray
*Standard

6. Exit 2 Tray
*Standard

Apeos C7070/C6570



Apeos C5570/C4570



Apeos C3570



3. Tandem Tray Module

- 520 sheets capacity tray x 2-tray
- 840 sheets capacity tray x 1-tray
- 1,230 sheets capacity tray x 1-tray

4. 4 Tray Module

- 520 sheets capacity tray x 4-tray

Optional

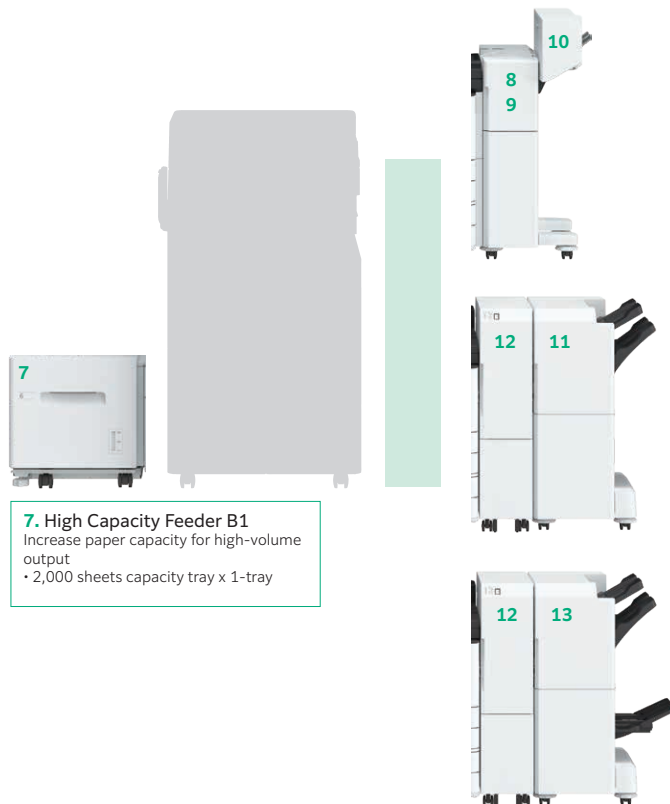

7. High Capacity Feeder B1

- Increase paper capacity for high-volume output
- 2,000 sheets capacity tray x 1-tray

8. Finisher B4

- Single stapling, Dual stapling



9. Punch Unit

- 2-hole / 4-hole punch



10. Booklet Maker

- Saddle Staple



11. Finisher-C4 2/4H

- Single stapling, Dual stapling
- 2-hole / 4-hole punch



12. Folder Unit CD3

- Z-fold Half Sheet, Tri-fold



13. Finisher-C4 with Booklet Maker 2/4H

- Single stapling, Dual stapling, Saddle stapling
- 2-hole / 4-hole punch



12. Folder Unit CD3

- Z-fold Half Sheet, Tri-fold



FUJIFILM

FUJIFILM Business Innovation Corp.

Headquarters

9-7-3, Akasaka Minato-ku, Tokyo 107-0052

TEL: +81-3-6271-5111

fujifilm.com/fbglobal

The available model varies depending on the country/region. Please ask the sales representatives for details.

The product specifications, appearance and other details in this brochure are subject to change without notice for improvements.

Reproduction Prohibitions Please note that reproduction of the following is prohibited by law: •Domestic and foreign currencies, government-issued securities, and national bonds and local bond certificates. •Unused postage stamps, post cards, etc. •Certificate stamps stipulated by law. •Reproducing works forming the subject matter of copyright (literary works, musical works, paintings, engravings, maps, cinematographic works, drawings, photographic works, etc.) is not permitted unless the reproduction is for the purpose of personal use, family use or other similar uses within a limited circle.

Trademarks •FUJIFILM and FUJIFILM logo are registered trademarks or trademarks of FUJIFILM Corporation. •Apeos is registered trademarks or trademarks of FUJIFILM Business Innovation Corp. •Adobe, Adobe logo, PostScript and PostScript logo are either registered trademarks or trademarks of Adobe in the United States and/or other countries. •Apple, AirPrint and Mac are trademarks of Apple Inc. registered in the U.S. and other countries and regions. •All product names and company names mentioned in this brochure are trademarks or registered trademarks of their respective companies.



For Your Safety

Before using the product, read the Instruction Manual carefully for proper use. Use the product with the power source and voltage specified. Be sure to establish ground connection. Otherwise, electronic shock may result in the case of a failure or short circuit.